

Operation Guide Setup Function

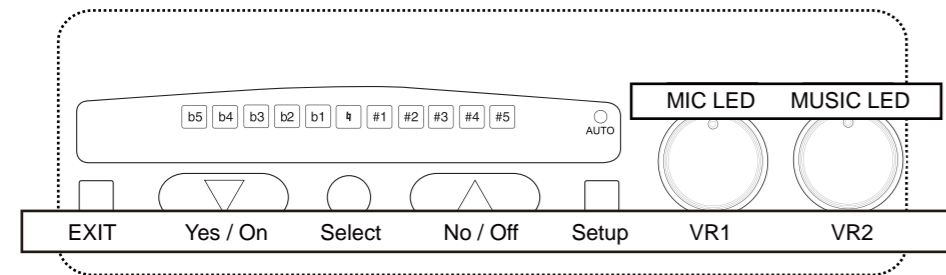

Entry Setup Function

- ① Power off
- ② [VR1], [VR2], turn to minimum, press and hold [Setup] button.
- ③ Power on. Wait 1Sec, and all LED will flashlight, Keep hold [Setup] button about 5 Sec.
- ④ Wait LED light then release [Setup] button.

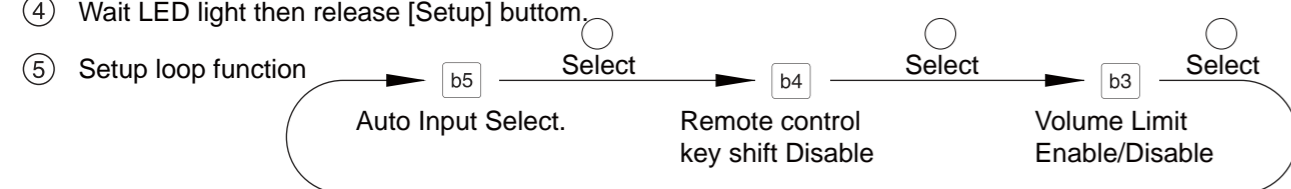

- ⑥ [EXIT], Exit setup mode

Auto Input Select :

b5 + AUTO (light) Auto input select : Enable .

b5 + AUTO (no light) Auto input select : Disable .

Select button: Enable (down arrow), Disable (up arrow)

Remote Control Key Shift Disable :

b4 + #1 Key Shift Disable : On .

b4 + #2 Key Shift Disable : Off .

Select button: On (down arrow), Off (up arrow)

Volume Initial / Limited :

b3 + MIC (light) + MUSIC (light) Volume Initial / Limit : Enable .

b3 + MIC (no light) + MUSIC (no light) Volume Initial / Limit : Disable .

Select button: On (down arrow), Off (up arrow)

Volume Initial Enable :

b3 + #1 #2 #3 #4 #5 + MIC (light) + MUSIC (light) Mic Volume Initial .

b3 + #1 #2 #3 #4 #5 + MIC (light) + MUSIC (no light) Mic Volume Limit .

b3 + #1 #2 #3 #4 #5 + MIC (no light) + MUSIC (light) Music Volume Initial .

b3 + #1 #2 #3 #4 #5 + MIC (no light) + MUSIC (no light) Music Volume Limit .

b3 + #1 #2 #3 #4 #5 + MIC (light) + MUSIC (light) Volume set Finish and Save.

Select button: Use Remote control set Volume (UP/DOWN arrows)

Specification

Amplifier

MUSIC POWER500W+500W

Audio input (sensitivity/impedance)

MIC.....1mv / 3.5k Ω
 DVD,AUX,TAPE.....250mv / 22k Ω
 BGM.....250mv / 22k Ω

Audio output (level/impedance)

PRE-OUT.....2.5v / 1k Ω
 REC OUT.....250mv / 470 Ω

Frequency response

MIC.....20Hz ~ 20kHz,+0 / -3dB
 MUSIC.....20Hz ~ 40kHz,+0 / -3dB

Tone control response

MUSIC Tone Bass.....±10dB(100Hz)
 Treble.....±10dB(10kHz)
 MIC Tone Bass.....±10dB(100Hz)
 Treble.....±10dB(10kHz)

Key control range.....15 steps ± 2.5tones

Video input

(sensitivity/input impedance).....1V_{p-p} / 75 Ω

Video output

(output level/output impedance).....1V_{p-p} / 75 Ω

Power Supply / Others

Power supply.....AC ~ 110/120V 50-60Hz
 AC ~ 220/240V 50-60Hz

Power consumption.....450W

Dimensions (W x H x D).....430 x 135 x 385 mm

Weight.....11Kg

Accessories

User's menu.....1
 Wireless remote control unit (RC-8-2)1
 AAA (R03, UM-4) batteries.....2
 Power supply cord.....1

• Designed and specifications subject to change without notice

KARAOKE AV AMPLIFIER

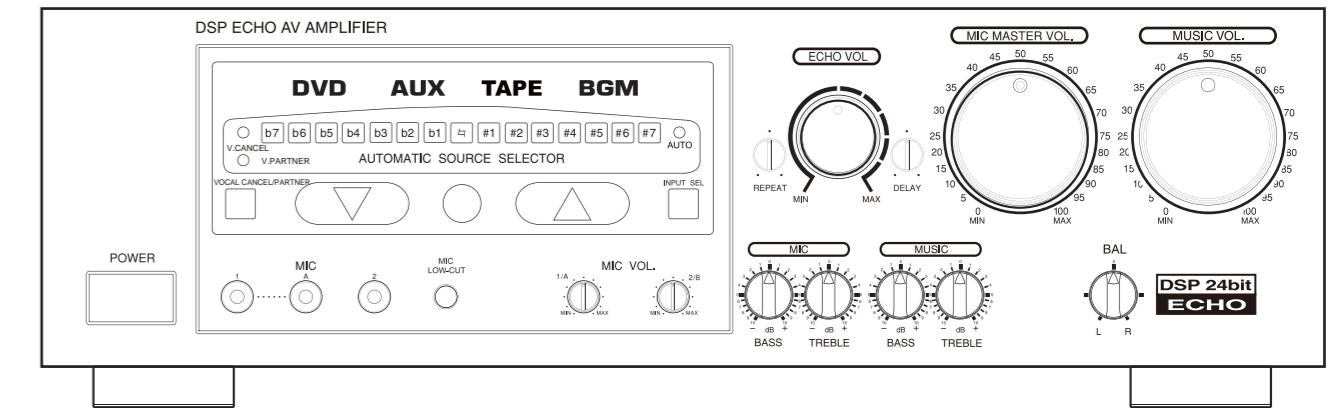

Features

- MUSIC POWER 500W+500W.
- Four line inputs & four video inputs.
- Recording OUTPUT terminal.
- Microphone low frequency and adjust the resonance.
- Adopt YAMAHA DSP YAD156 high-end 3D key-control chip.
- Effector terminal digital multi echo.
- 6 Microphones available simultaneously.
- Wireless remote controller.

- Thank you very much for purchasing our KARAOKE AV Amplifier.
- Please read through this User's Manual for proper operation of this model.
- After you have finished reading the manual, put them away in a safe place for future reference.

User's Manual

Terms and Functions

Operation Guide for Front Panel

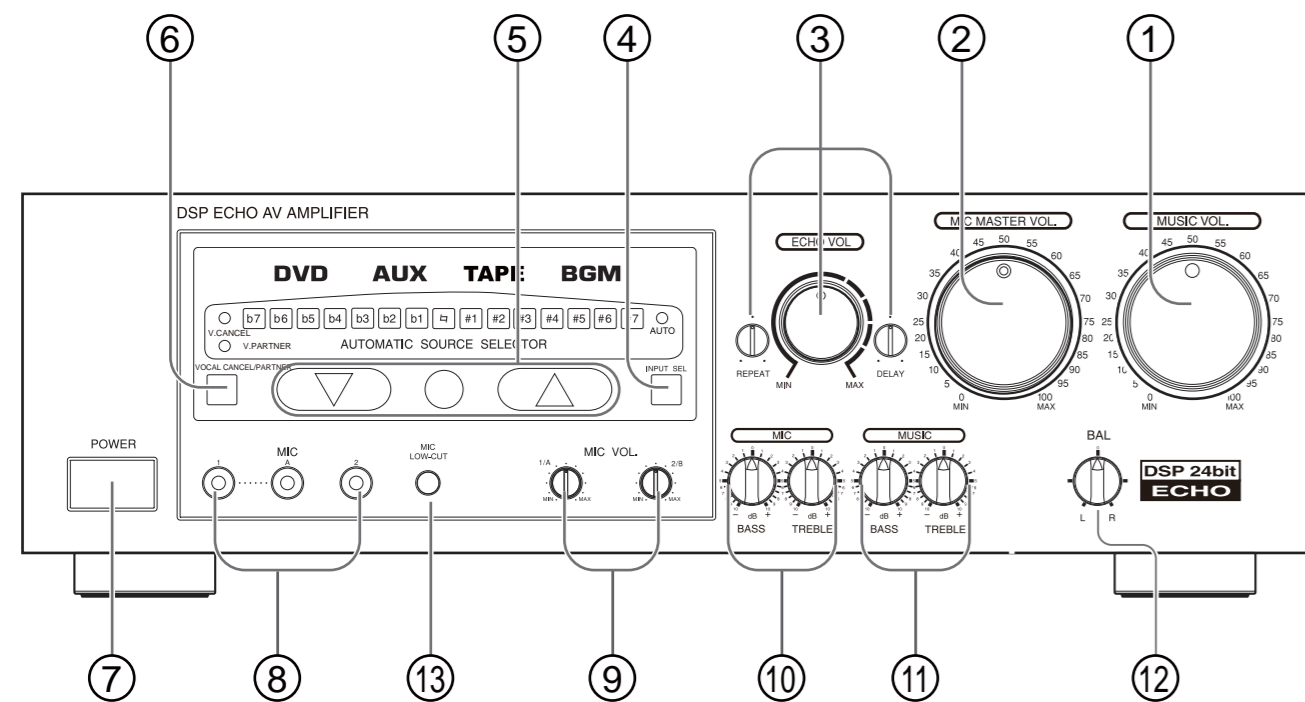

- 1 MUSIC VOLUME**
This knob is used for adjusting the volume of music.
- 2 MIC MASTER VOLUME**
This knob is used for adjusting the volume of microphones. Turn right for increasing the volume, and left for decreasing.
- 3 ECHO VOLUME**
This knob is used for adjusting echo effect. Turn right for boosting the effects, and left for cuttings.
DELAY Control : Adjust the delay time.
REPEAT Control : Adjust the interval of repetitions.
- 4 INPUT SELECT**
The location of signal - to - input can be selected by this button. Press and hold the button for over 4Sec. to enable or disable the "AUTO INPUT SELECT" function.
- 5 KEY CONTROL**
These buttons are used for adjusting the music scale. Each step is for 1/4 tone, and the middle button is for the original / standard key . After changing a song, or after the music has been terminated for more than 2 seconds, the system will automatically return to the original key.
- 6 VOCAL Select**
PARTNER : Automatic vocal performance when there is no input to any of the MIC connected to the MIC jacks.
MULTI : Vocal accompaniment function.
- 7 POWER**
Press this switch to turn the power ON/OFF.
- 8 MIC INPUT (1 , A , 2)**
TRS 1/4" input jacks for unbalanced or balanced microphone.
- 9 MIC VOL CONTROL (1/A , 2)**
 - 1/A : Adjusting the microphone input level of MIC 1 and MIC A.
 - 2 : Adjusting the microphone input level of MIC 2.
- 10 MIC TONE BASS/TREBLE**
Adjusts the microphone input by boosting low or high frequency, respectively.
- 11 MUSIC TONE BASS/TREBLE**
Adjusts the music input by boosting low or high frequency, respectively.
- 12 BALANCE**
Adjusts the balance between the right and left channel levels output from the speakers.
- 13 MIC Low-Cut Control**
Switch the microphone input low frequency cut.

Terms and Functions

Operation Guide for Rear Panel

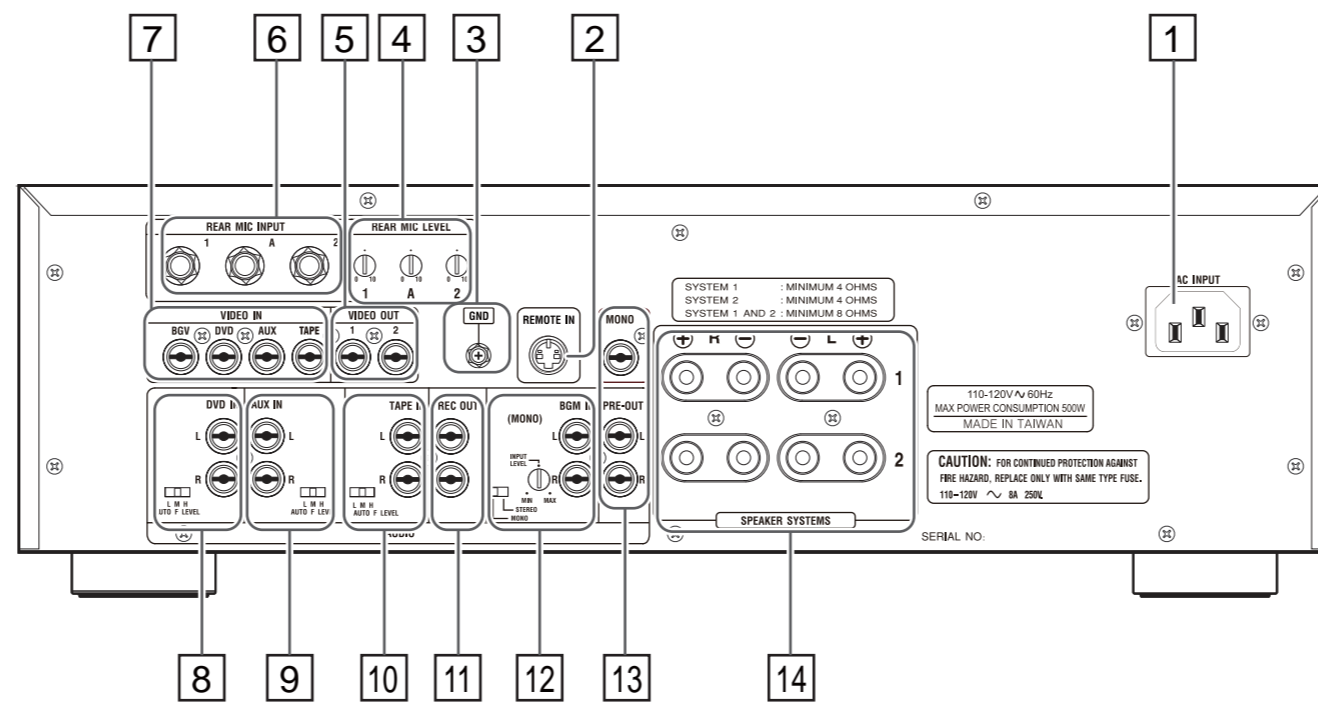

- 1 AC POWER IN**
To household power outlet.
* Wait until connections have been completed before connecting the power cord.
- 2 REMOTE Input Jack**
Control device through an external device, such as an external IR sensor or an external control panel.
- 3 GROUND Terminal**
The grounding wire shall be connected to a grounding line to reduce the risk of electric shock.
- 4 MIC VOL CONTROL (1 , A , 2)**
Microphone input , independently adjust the input volume.
- 5 Video Output Jacks (1 , 2)**
Connect to video devices such as a TV, projector, monitor, etc. The condition of the AMP can be easily observed through a video device.
- 6 REAR MIC Input Jacks (1 , A , 2)**
TRS 1/4" input jacks for unbalanced or balanced microphone.
- 7 Video Input Jacks (DVD , AUX , TAPE , BGV)**
Receive video input from other devices. The received signal is output through an audio output jack according to the chosen channel.
- 8 DVD Player Audio Input Jacks**
Connect the audio output jacks of DVD player here.
* **DVD SENSITIVITY Switch**
This switch sets the sensitivity level at which the systems auto-selector detects a DVD signal and auto-changes it as the current input channel. Set to LOW if other channels do not auto-enable properly. Set to MIDDLE for standard use. Set to HIGH if unwarranted auto-selection change occur.
- 9 AUX Audio Input Jacks**
Connect the audio output of auxiliary component such as a cable broadcasting tuner.
* **AUX SENSITIVITY Switch**
This switch sets the sensitivity level at which the systems auto-selector detects a AUX signal and auto-changes it as the current input channel. Set to LOW if other channels do not auto-enable properly. Set to MIDDLE for standard use. Set to HIGH if unwarranted auto-selection change occur.
- 10 TAPE Audio Input Jacks**
Connect the audio output jacks of TAPE deck here.
* **TAPE SENSITIVITY Switch**
This switch sets the sensitivity level at which the systems auto-selector detects a TAPE signal and auto-changes it as the current input channel. Set to LOW if other channels do not auto-enable properly. Set to MIDDLE for standard use. Set to HIGH if unwarranted auto-selection change occur.
- 11 REC OUT**
Connect the input jacks of the TAPE deck to these jacks.
The REC OUT audio output is the mixture of the microphone and musical signals. This output is not only supplied during tape recording but is output permanently.
- 12 BGM Audio Input Jacks**
Connect the input jacks of equipments for background music or public channels.
* **BGM INPUT LEVEL Control**
Adjust this control to optimize the BGM input level. Note: BGM volume control can only be adjusted here and cannot be adjusted by the master volume control.
* **MONO/STEREO Switch**
This switch selects the BGM mode's output to be either MONO or STEREO.
- 13 PRE-OUT**
Connect the input jacks of the extension Power amplifier or the Mixer to these jacks.
- 14 SPEAKER SYSTEMS**
SPEAKER IMPEDANCE
System 1 : Minimum 4 Ohms.
System 2 : Minimum 4 Ohms.
System 1+2 : Minimum 8 Ohms.

Operation Guide for Remote Control

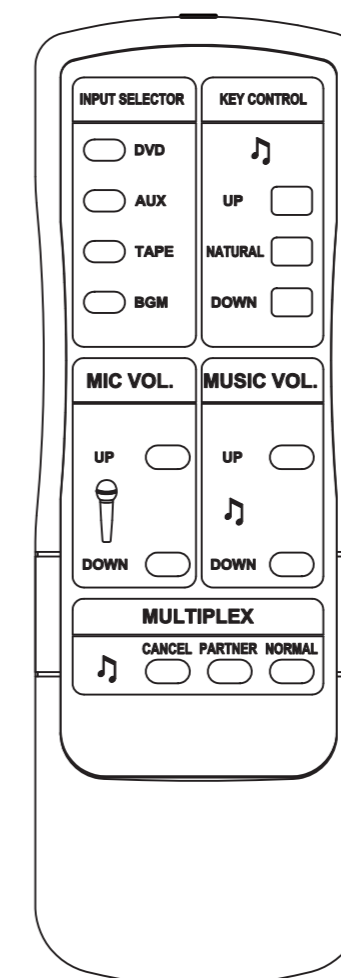

- INFRARED TRANSMIT
Please don't cover this position.
- INPUT SELECT
Selection/Switch of inputted audio signals
- KEY CONTROL
UP : Press to transpose the key of music 1/4 tone UP per set.
NATURAL : Press to reset music to ORIGINAL key.
DOWN : Press to transpose the key of music 1/4 tone DOWN per set.
- MIC VOLUME
Press to UP or DOWN the volume of the master microphone output.
- MUSIC VOLUME
Press to UP or DOWN the volume of the master music output.
- MULTIPLEX
NORMAL : General audio output and vocal performance.
PARTNER : Automatic vocal performance when there is no input to any of the MIC connected to the MIC jacks.
MULTI : Vocal accompaniment function.
* This function is available only when the audio and video source is of KARAOKE format.